

Smartmi Air Purifier User Manual

Warning

- When the power cord is damaged, it must be replaced with a genuine power cord purchased from the manufacturer or after-sales service department.
- This appliance can be used by children aged from 8 years and above and persons with reduced physical, sensory or mental capabilities or lack of experience and knowledge if they have been given supervision or instruction concerning use of the appliance in a safe way and understand the hazards involved.
- Children shall not play with the appliance. Cleaning and user maintenance shall not be made by children without supervision.

Precautions

- Turn off and unplug the purifier before moving it.

- The purifier cannot turn on when the fan grille and the filter compartment cover are not installed properly.
- Maintain a distance of at least 20 cm between the air inlets and walls or other objects.
- The purifier must be placed on firm and flat floor.

- Prior to cleaning or other maintenance, the appliance must be disconnected from the supply mains.
- Frequently remove dust, hair, and other particles from the outer mesh screen of the filter, so as to reduce the chance of bacteria growth.
- Remove dust, hair, and particles from the purifier's air inlets to prevent a reduction of air intake.
- Cover the air outlet to prevent dust, hair, and other particles from falling in when the purifier is left unused for a long time.

To avoid fire, electric shocks, or other damage, use the power cord and electrical outlet as instructed below:

- Do not excessively pull, twist or bend the power cord, as this may expose or break the cord's core.
- The power cord must be plugged into a suitable electrical outlet.
- Use the power cord that is provided with the purifier, do not use any third party power cords.
- Always unplug the purifier before carrying out maintenance to or moving the air purifier.

- Immediately stop using the purifier when it makes unusual sounds, gives off bad odors, overheats, or its fan rotates irregularly.
- Do not stick your fingers or foreign objects into the protective parts, movable parts, air inlets, or air outlets.
- Keep objects such as hairs or fabrics away from the purifier to avoid blocking the air inlets or air outlets.
- Do not sit on, lean on or tilt the purifier.
- When using in conjunction with gas-fueled appliances (such as gas stoves, gas heaters), please ventilate sufficiently to avoid carbon monoxide poisoning.
- Do not pour liquids, nor throw powders or other small substances into the purifier's air outlet.

Do not use the purifier in the following circumstances, as they may result in electric shocks, fire, or other damage:

- Near open flames, such as candles, incense burners, stoves, fireplaces, cigarettes, firecrackers, lighters, multipurpose torches, candle lighters, or fire pans.
- Near appliances that generate high temperatures, such as electric heaters, fan heaters, electric foot warmers, electric stoves, electric irons.
- Make sure no inflammable objects get into the purifier.
- In unstable locations where the purifier can easily fall over.
- In environments that are extremely hot, humid, or damp, such as bathrooms.

Product Overview

Read this manual carefully before use, and retain it for future reference.

Note: In this manual, the illustrations of the product and its accessories and the user interface are schematic diagrams for reference only. The actual product may vary from that shown in the schematic diagrams due to product updates and upgrades. Please refer to the actual product.

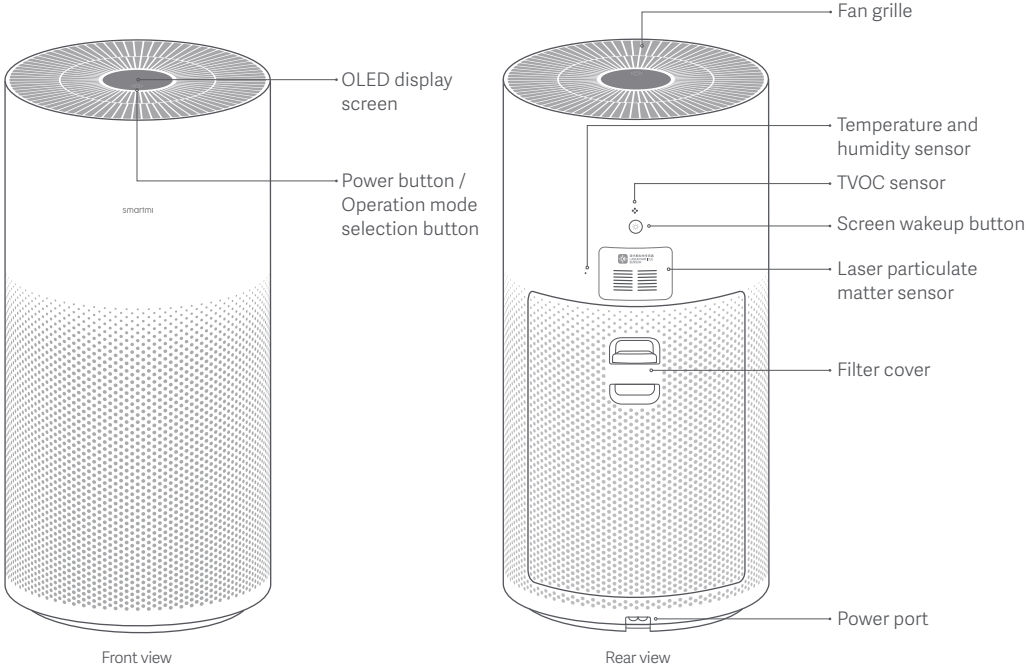

Product Overview

Screen display

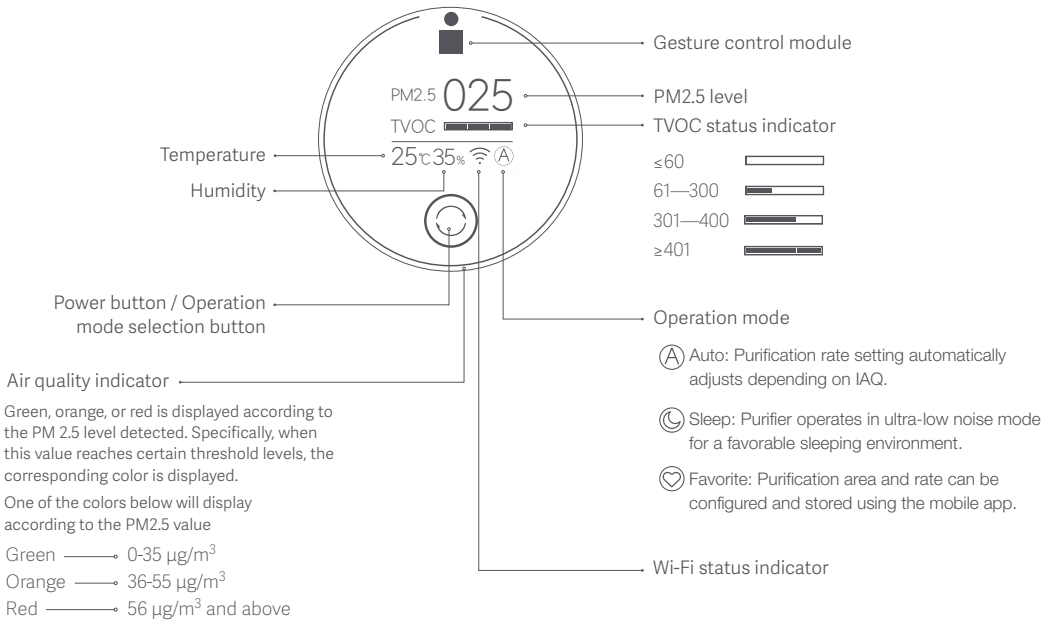

Installation

Placing the humidifier at an appropriate place

To allow the purifier to operate as effectively as possible, maintain a suitable distance between its air inlet and obstructions such as walls (see figure above).

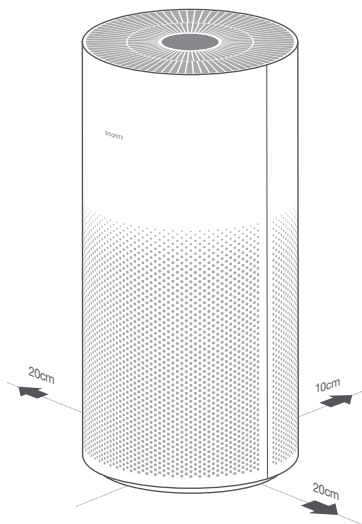

Connecting to power supply

Connect power cord to the power port at the bottom of the main unit. Then connect the power cord to a power socket.

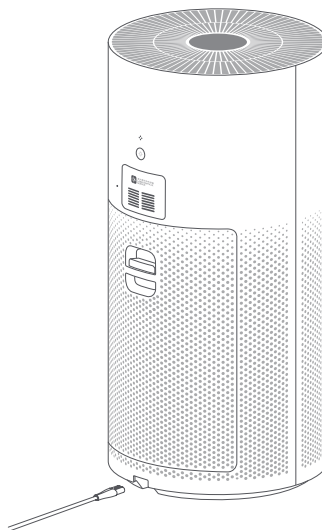

Note: For optimal air purification, keep doors and windows closed during use.

Use



Power button / Operation mode selection button

Touch to power on the device. After powering on, gently touch this button to select operation mode; long press (for 2 s) to power off the device.

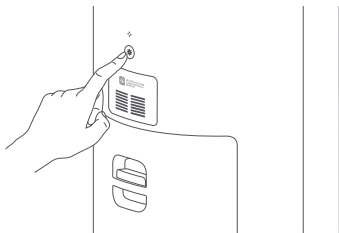

Screen wakeup button

Press the screen wakeup button at the rear of the main unit to adjust display brightness, or enable or disable the display.

Gesture control operations

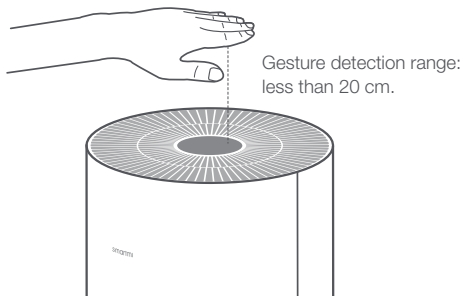

Operation mode selection

On the home page, air swipe left or right to select the operation mode. The home page will be displayed if no instruction is detected within 3 s.

Powering off

While the device is powered on, hold your hand above the screen for 6 s to power off it.

QR code for installing "Mi Home/Xiaomi Home" app

On the home page, air swipe up to display the QR code for installing the "Mi Home/Xiaomi Home" app. Air swipe down to return to the home page. The home page will be displayed if no instruction is detected within 10 s.

Displaying remaining filter life (%)

On the home page, air swipe down to view remaining filter life (%), and up to return to the home page. The home page will be displayed if no instruction is detected within 10 s.

Note: You can disable gesture control functionality in the app.

Use

Resetting Wi-Fi

If your phone cannot connect to the purifier, press the power operation mode selection and screen wakeup buttons simultaneously, and hold for 5 s. An alert tone will indicate that the Wi-Fi has been reset successfully.

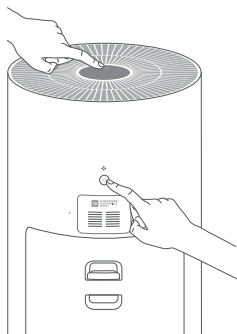

Connect with Mi Home / Xiaomi Home App

This product works with Mi Home / Xiaomi Home app*. Control your device with Mi Home / Xiaomi Home app.



Scan the QR code to download and install the app. You will be directed to the connection setup page if the app is installed already. Or search "Mi Home / Xiaomi Home" in the app Store to download and install it.

Open Mi Home / Xiaomi Home app, tap "+" on the upper right, and then follow prompts to add your device.

*The app is referred to as Xiaomi Home app in Europe (except for Russia). The name of the app displayed on your device should be taken as the default.

Note: The version of Mi Home app might have been updated, please follow the instructions based on the current app version.

Filter status reminder

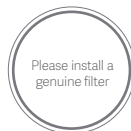

1 Filter installation reminder

Filter not detected, or installed filter is not genuine.

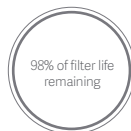

2 Filter life reminder

When the purifier detects remaining filter life more than 10%, disconnect the power and open the filter cover; the filter life remaining will be displayed on the screen.



3 Filter replacement reminder

Filters should be replaced every 6–12 months. When the purifier detects remaining filter life of 10% or less, the screen will display a QR code, and the percentage filter life remaining, each time the purifier is powered on.

Note: For details on how to replace the filter, see "Filter Replacement" instructions on rear side of filter cover.

Note: Since it contains activated carbon, when saturated, the filter will retain the odor of the harmful gases it has absorbed. Leaving a used filter in a place with adequate light and ventilation will allow the activated carbon to recover, partially restoring the filter's absorption capability. Timely replacement of the filter once the recommended filter life is over is advised.

Maintenance and care

⚠ Power off purifier and disconnect it from the power supply before performing the following operations.

Cleaning the filter housing

To maintain optimal ventilation and purification efficiency, remove any dust on the ventilation holes and housing walls using a vacuum cleaner or soft cloth.

Note: Do not spray liquid onto the purifier's casing, or wipe it using a wet cloth. This could lead to drops of water leaking into the base of the device.

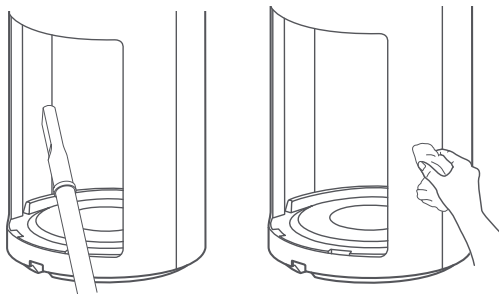

Cleaning laser particulate matter sensor

The catch of the particulate matter (PM) sensor cover flap is on the rear cover just above the filter housing. Press the catch upwards and open the sensor flap (see Figure a).

Clean the filter screen and sensor (located as in Figure b) using an air blow gun or hair dryer.

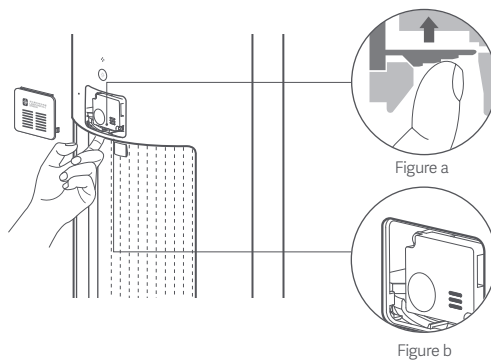

Note: Do NOT clean with hot air.

Specifications

Name	Smartmi Air Purifier	Rated Voltage	100-240 V~	Clean Air Delivery Rate (CADR Particles)	400 m ³ /h
Model	KQJHQ01ZM	Rated Frequency	50/60 Hz	Formaldehyde Clean Air Delivery Rate (CADR Formaldehyde)	60 m ³ /h
Item Dimensions	φ 260 × 535 mm	Rated Power	40 W	Particle Purification Efficiency	High
Net Weight	Approx. 4.9 kg	Noise Level	64 dB(A)	Formaldehyde Purification Efficiency	High
Recommended Surface	28–48 m ² *	Wireless Connectivity	Wi-Fi IEEE 802.11 b/g/n 2.4GHz		
RF Specification: Wi-Fi 2.4G (2400 - 2483.5 MHz), Max. RF Output Power: <20 dBm RFID (13.56MHz), Max. Magnetic Field Strength: <83 dBμA/m@3m Under normal use of condition, this equipment should be kept a separation distance of at least 20cm between the antenna and the body of the user.					

*Standards: Q/BJZMK0001–2018

Regulatory Compliance Information

Europe — EU declaration of conformity

CE Hereby, Beijing Smartmi Electronic Technology Co., Ltd. declares that the radio equipment - Smartmi Air Purifier, type KQJHQ01ZM is in compliance with Directive 2014/53/EU. The full text of the EU declaration of conformity is available at the following internet address: <http://smartmi.com.cn/doc.html>

Disposal and recycling information



All products bearing this symbol are waste electrical and electronic equipment (WEEE as in directive 2012/19/EU) which should not be mixed with unsorted household waste. Instead, you should protect human health and the environment by handing over your waste equipment to a designated collection point for the recycling of waste electrical and electronic equipment, appointed by the government or local authorities. Correct disposal and recycling will help prevent potential negative consequences to the environment and human health. Please contact the installer or local authorities for more information about the location as well as terms and conditions of such collection points.

